

CARATTERISTICHE DIMENSIONALI:





TABELLA "A"

A	A"	B	F	H	L min	L max	 g	WFL kg	FUNE Ø min	 n	CODICE
M5	3/16	80	8	16	118	175	48	115	2.0	400	080050105
M6	1/4	80	10	20	130	193	62	160	2.5	300	080050106
M8	5/16	105	11	22	158	240	109	300	2.5	200	080050108
M10	3/8	125	14	27	192	289	194	470	3.5	100	080050110
M11	7/16	135	15	29	206	310	267	580	3.5	80	080050111
M12	1/2	140	17	33	226	332	325	690	4.0	60	080050112
M14	9/16	170	18	35	256	386	520	940	4.0	35	080050114
M16	5/8	190	23	46	290	435	790	1290	6.0	/	080050116
M18	11/16	205	28	59	358	512	1260	1660	7.0	/	080050118
M20	3/4	220	28	59	358	522	1530	2130	7.5	/	080050120
M22	7/8	240	34	70	400	579	2220	2630	9.0	/	080050122
M24	1"	260	36	76	436	628	2740	3060	10.0	/	080050124
M27	1"1/8	270	38	82	474	668	4770	4000	11.0	/	080050125
M30	1"3/16	280	40	86	498	694	5250	4860	11.5	/	080050130
M33	1"1/4	290	41	89	516	732	5880	6040	12.0	/	080050126
M36	1"3/8	300	43	95	532	740	7220	6500	13.0	/	080050136
M39	1"1/2	300	45	102	544	743	8850	7900	14.0	/	080050139

Le quote indicate sono espresse in mm.

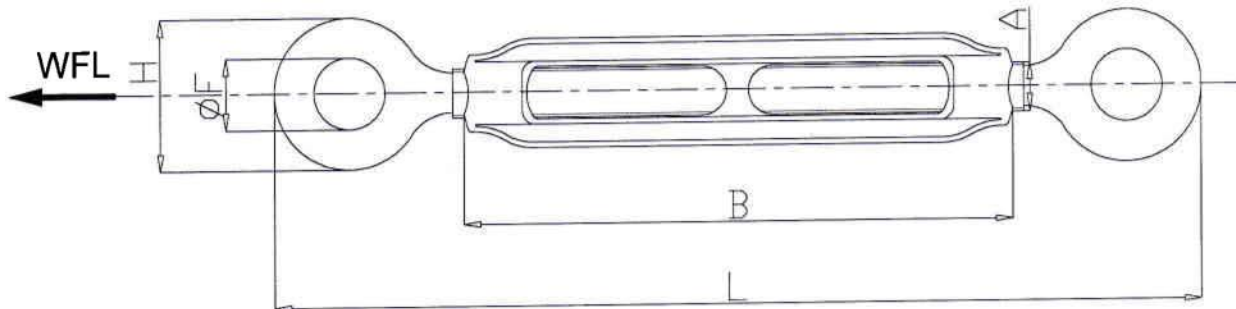
WFL = FORZA LIMITE DI LAVORO

COEFFICIENTE DI SICUREZZA: 4